

WIRRAL BOROUGH COUNCIL

TOWN AND COUNTRY PLANNING 1971

TOWN AND COUNTRY PLANNING GENERAL DEVELOPMENT ORDER 1988

DIRECTION UNDER ARTICLE 4

THE WIRRAL BOROUGH COUNCIL (BROMBOROUGH POOL VILLAGE) DIRECTION 1990

WHEREAS Wirral Borough Council (hereinafter called "the Council") is the appropriate Local Planning Authority within the meaning of the Town and Country Planning General Development Order 1988 (hereinafter called "the Order") in respect of the area more particularly described in the First Schedule hereto

AND WHEREAS the Council is satisfied that it is expedient that development of the classes specified below and more particularly in the Second Schedule hereto should not be carried out in the said area unless planning permission is expressly granted by the Council pursuant to an application made therefor

AND WHEREAS the Council consider that the development specified in Schedule 2 hereto would be prejudiced<sup>ial</sup> to the proper planning of the area described in Schedule 1 hereto or would constitute a threat to the amenities of the said area

AND WHEREAS by virtue of Article 5(6) of the Order this Direction shall not take effect unless and until it is approved by the Secretary of State for the Environment and notice given in connection with Article 5(10) of the Order

NOW THEREFORE THE COUNCIL HEREBY DIRECTS in pursuance of Article 4 of the Order that the permission granted by Article 3 of the Order shall not apply to the development comprised within Classes A, B, C, D and H referred to in Part 1 and Class A of Part 2 of Schedule 2 to the Order (and which classes of development are set out in full in the Second Schedule to this Direction) and not being development comprised in any other Class.

### THE FIRST SCHEDULE

The area consisting of those pieces or parcels of land and buildings thereon known as Bromborough Pool Village Bromborough in the Borough of Wirral in the County of Merseyside more particularly delineated on the plan hereto annexed and shown thereon surrounded by the red line

### THE SECOND SCHEDULE

The development described in Classes A B C D and H of Part 1 and Class A of Part 2 of Schedule 2 to the Town and Country Planning General Development Order 1988 as follows :-

#### PART 1

Class A - The enlargement, improvement or other alteration of a dwellinghouse.

Class B - The enlargement of a dwellinghouse consisting of an addition or alteration to its roof.

Class C - Any other alteration to the roof of a dwellinghouse.

Class D - The erection or construction of a porch outside any external door of a dwellinghouse.

Class H - The installation, alteration or replacement of a satellite antenna on a dwellinghouse or within the curtilage of a dwellinghouse.

PART 2

Class A - The erection, construction, maintenance, improvement or alteration of a gate, fence, wall or other means of enclosure.

THE COMMON SEAL of  
WIRRAL BOROUGH COUNCIL  
was hereunto affixed in  
the presence of :-



*PH London*  
Authorised Officer

NUMBER IN SEAL BOOK - 20011

Dated this 22nd day of August 1990

The Secretary of State for the Environment  
hereby approves the foregoing direction.

*St Greenwood*

Signed by authority  
of the Secretary of  
State

A Regional Controller  
in the Department of  
the Environment.

*2nd November* 1990

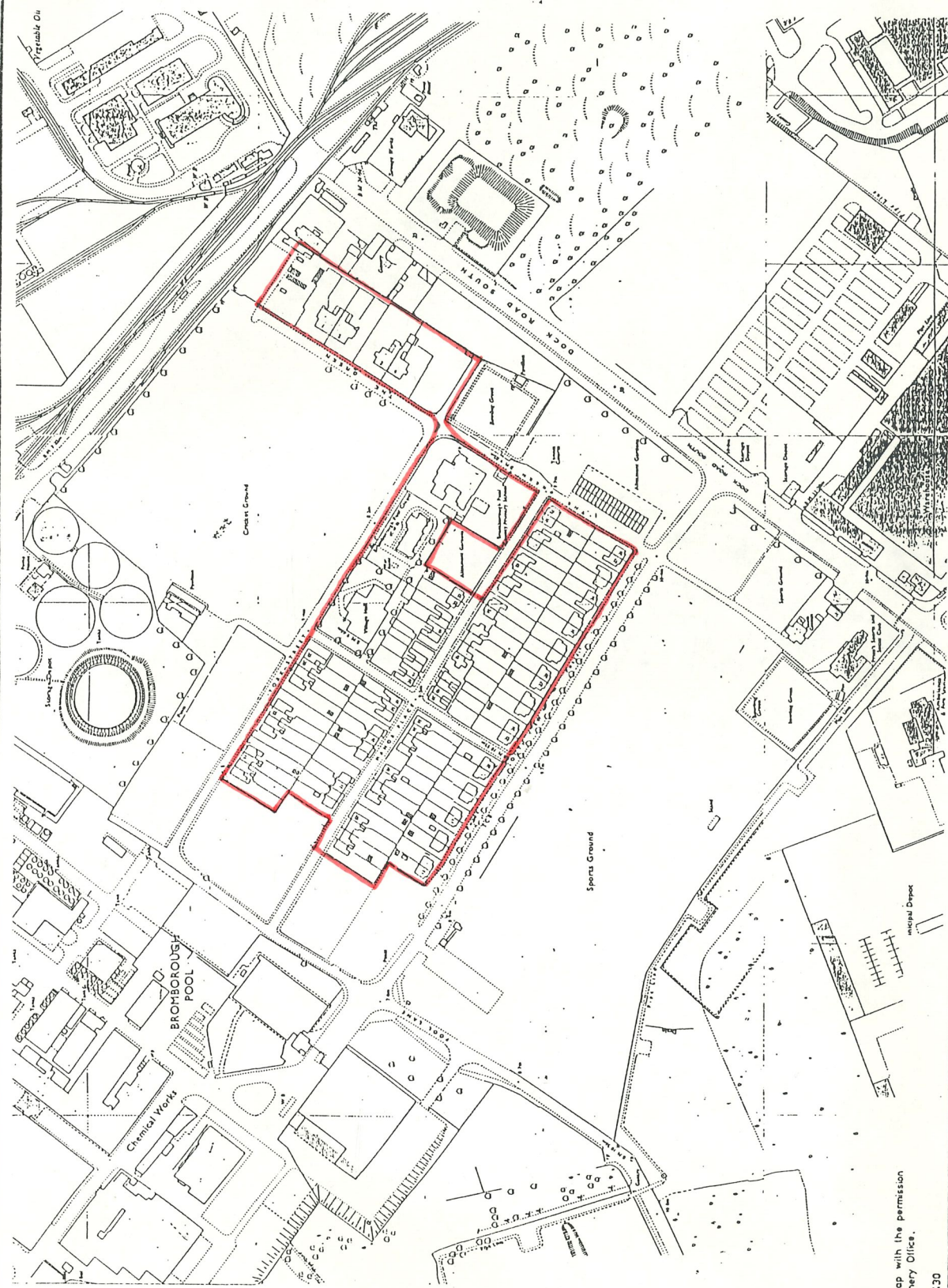

*J. Wilkie*

Reproduced from the Ordnance Survey Map with the permission of the Controller of Her Majesty's Stationery Office. Crown Copyright reserved. Metropolitan Borough of Wirral. L.A.076430

**METROPOLITAN BOROUGH OF WIRRAL**

**J. WILKIE**  
*Director*  
 Department of Planning and Economic Development  
 Municipal Offices, Brighton Street, Wallasey, L44 8ED.



TITLE  
**WIRRAL BOROUGH COUNCIL  
 (BROMBOROUGH POOL VILLAGE)  
 ARTICLE 4 DIRECTION 1990**

DRWG. No.  
**2070/88**

DRAWN C.E.  
 DATE 20-8-90

SCALE 1:2500