

THE WIRRAL BOROUGH COUNCIL LAND ADJACENT TO HOOTON MOUNT COTTAGE,
EASTHAM VILLAGE ROAD, EASTHAM, WIRRAL
ARTICLE 4 DIRECTION

TOWN AND COUNTRY PLANNING (GENERAL PERMITTED
DEVELOPMENT) ORDER 1995

DIRECTION MADE UNDER ARTICLE 4(1) TO WHICH ARTICLE 5(4) APPLIES

WHEREAS Wirral Borough Council being the appropriate Local Planning Authority within the meaning of Article 4(6) of the Town and Country Planning (General Permitted Development) Order 1995, are satisfied that it is expedient that development of the description set out in the Schedule below should not be carried out on land shown edged red on the attached plan, unless permission is granted on an application made under Part III of the Town and Country Planning Act 1990,

AND WHEREAS the Council consider that development of the said description would be prejudicial to the proper planning of their area and would constitute a threat to the amenities of their area and that the provisions of paragraph 4 of Article 5 of the Town and Country Planning (General Permitted Development) Order 1995 apply,

NOW THEREFORE the said Council in pursuance of the power conferred on them by Article 4(1) of the Town and Country Planning (General Permitted Development) Order 1995 hereby direct that the permission granted by Article 3 of the said Order shall not apply to development on the said land of the description set out in the Schedule below

THIS DIRECTION is made under Article 4(1) of the said Order and, in accordance with Article 5(4), shall remain in force until 30 December 2000 (being six months from the date of this Direction) and shall then expire unless it has been approved by the Secretary of State for the Environment

SCHEDULE

The erection, construction, maintenance, improvement or alteration of a gate, fence, wall or other means of enclosure being development comprised within Class A of Part 2 of Schedule 2 to the General Permitted Development Order 1995 and not being development comprised within any other class.

THE COMMON SEAL of

WIRRAL BOROUGH COUNCIL

was affixed to this Direction

this 30th day of June 2000



Authorised Officer



The Secretary of State for the Environment, Transport and the Regions hereby approves the foregoing Direction.

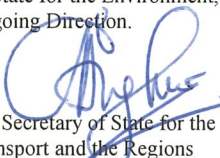

Authorised by the Secretary of State for the Environment, Transport and the Regions

Director (Planning)
in the Government Office
for the North West

12 December 2000

NUMBER IN SEAL BOOK 36302

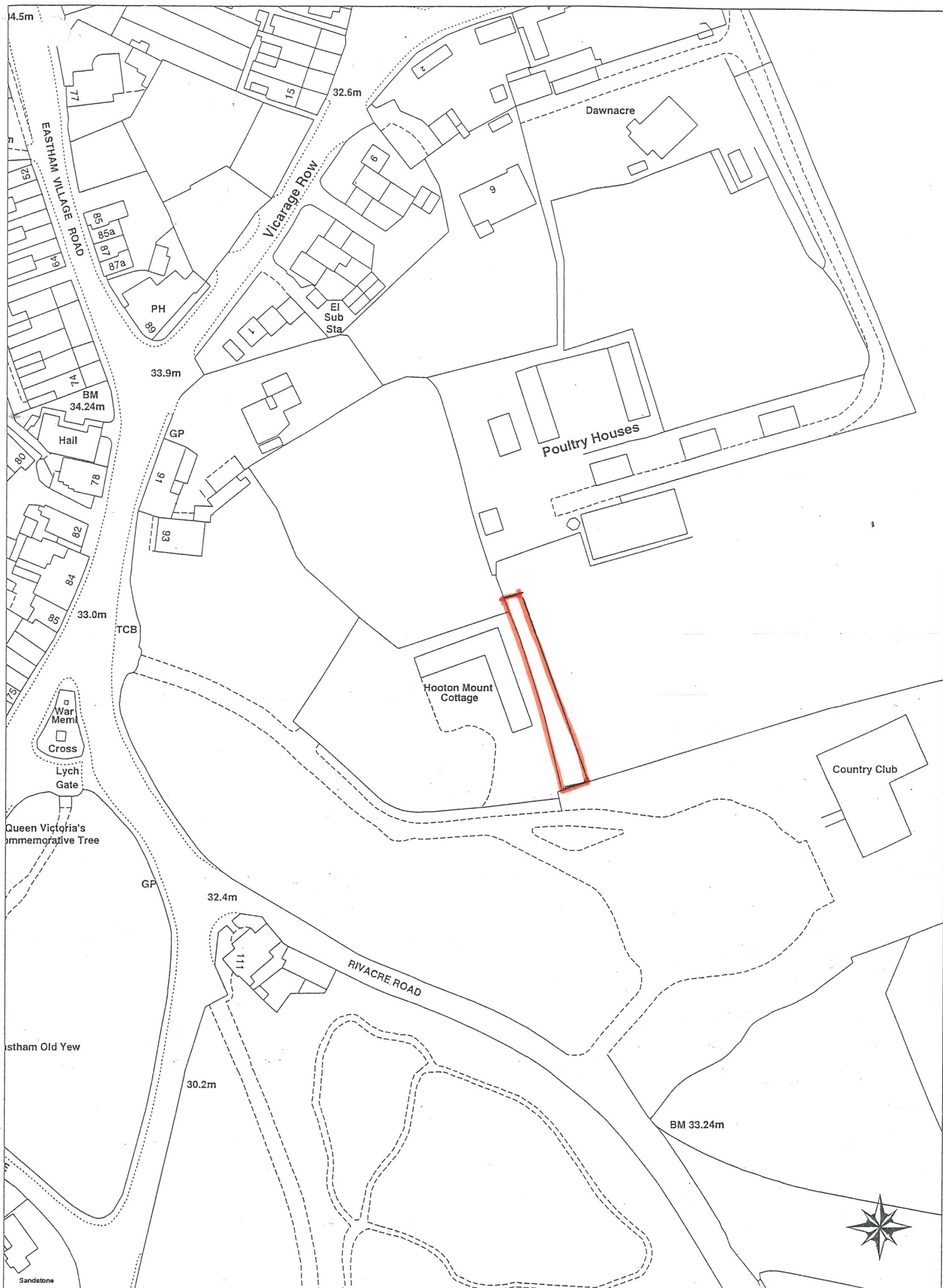

This copy has been produced specifically for Planning and Building Control purposes only. No further copies may be made. Reproduced from the Ordnance Survey's mapping with the permission of the Controller of Her Majesty's Stationery Office. © Crown copyright. Unauthorised reproduction infringes Crown copyright and may lead to prosecution or Civil proceedings. Wirral Metropolitan Borough Council Licence LA 076430

Scale: 1:1250

Date: 16/02/2000

