

THIS DIRECTION IS ISSUED ON BEHALF OF THE CHESHIRE COUNTY COUNCIL

WIRRAL URBAN DISTRICT COUNCIL

TOWN & COUNTRY PLANNING ACT 1962

THE WIRRAL URBAN DISTRICT (PIPERS LANE,
HESWALL) DIRECTION, 1963

WHEREAS the Urban District Council of Wirral (hereinafter called "the Council") act on behalf of the Local Planning Authority as respects the land in the urban district more particularly described in the First Schedule hereto

AND WHEREAS the Council are satisfied that it is expedient that development of the class specified in the Second Schedule hereto should not be carried out in the said area unless permission is granted on an application in that behalf

1. THE COUNCIL HEREBY DIRECT in pursuance of Article 4 of the Town & Country Planning General Development Order 1963 that the permission granted by Article 3 of the said Order shall not apply to the development specified in the Second Schedule hereto on the land described in the First Schedule hereto

2. THIS DIRECTION may be cited as "The Wirral Urban District (Pipers Lane Heswall) Direction 1963" and shall come into force on the date on which notice thereof is served on the occupier of the land or if there is no occupier on the owner of the land

THE FIRST SCHEDULE

Land at the Northerly extremity of Pipers Lane Heswall comprising 12.5 acres or thereabouts being Parcel Numbers 9702, 9210, 9796, 1296 and 1103 on Cheshire Ordnance Sheets SJ 2483, 2482, 2582 and 2583. 1956 Edition more particularly delineated on the plan annexed hereto and thereon edged red

THE SECOND SCHEDULE

The development described in Paragraph 1 of Class VI of Part I of the First Schedule to the Town & Country Planning General Development Order 1963

DATED this 23rd day of December 1963.

THE COMMON SEAL of the
Wirral Urban District
Council was hereunto
affixed in the presence
of :-



1338

[Handwritten signature]

Chairman of the Council

[Handwritten signature]

Clerk of the Council

H.L.C. 15434

The Minister of Housing and Local Government hereby approves the foregoing direction.



Given under the official seal of the
Minister of Housing and Local Government

[Handwritten signature]

**Assistant Secretary,
Ministry of Housing and Local Government.**

DGV.

31st March 1964.

PLAN REFERRED TO IN THE WIRRAL URBAN DISTRICT
 [PIPERS LANE HESWALL] DIRECTION 1963.

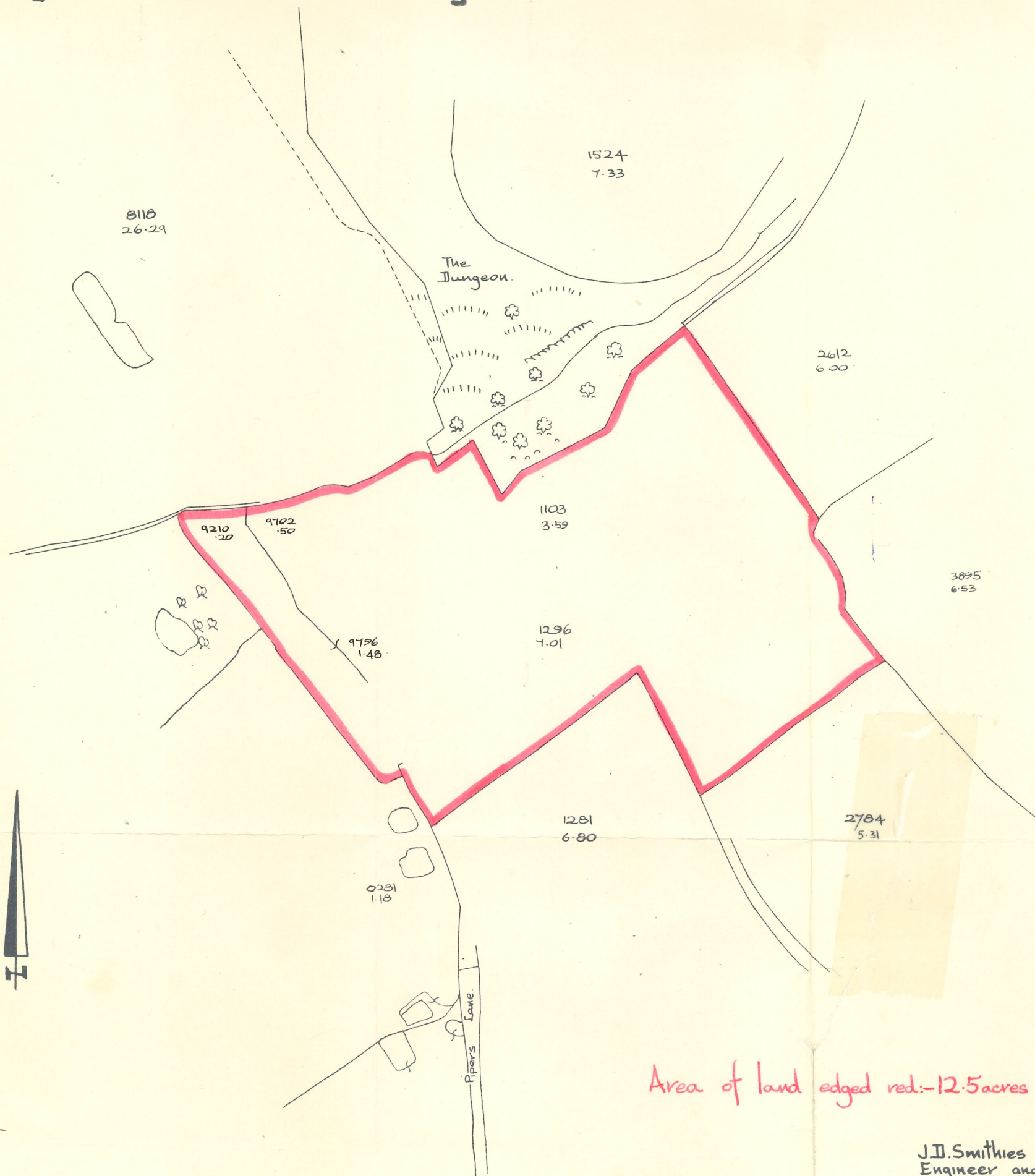

Area of land edged red:-12.5 acres or thereabouts

J.I. Smithies A.M.I.Mun.E.
 Engineer and Surveyor
 Council Offices
 Heswall.

Scale: 1/2500.

Neg. No: 634. Dwg. No: 1424.

December 1963 Tracing of Cheshire Ordnance Sheets S.J. 2483, 2482, 2582, 2583. 1956 Edition.